

INSTRUCTION BOOK AND PARTS LIST



EASTMAN'S NEW ULTRONIC[®] CUTTING MACHINE

**Eastmanmachine
COMPANY**

778 WASHINGTON STREET
BUFFALO, NEW YORK 14203

SHARPENER HOUSING ASSEMBLY (FRONT VIEW) SEE PAGES 16 AND 17

SHARPENER HOUSING ASSEMBLY (REAR VIEW) SEE PAGES 18 AND 19

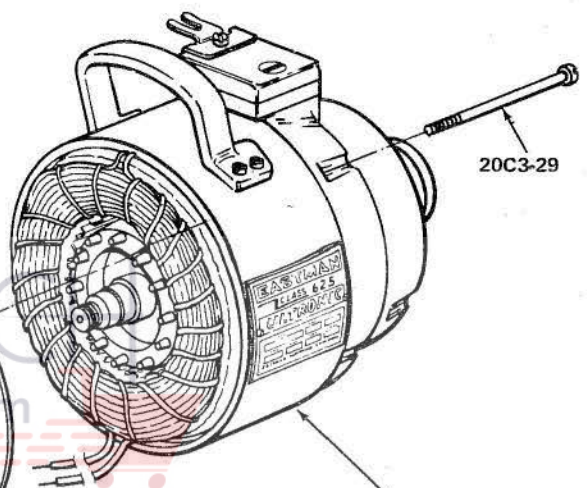

MOTOR ASSEMBLIES SEE PAGES 10, 11, 12 AND 13

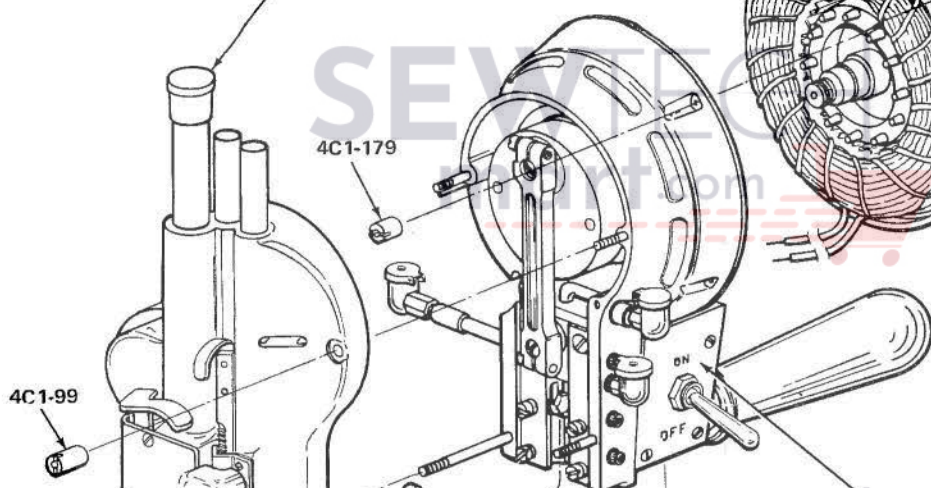

4C1-99

4C1-179

4C1-150

FOR KNIFE SEE PAGE 5

FRONT BEARING HOUSING ASSEMBLY SEE PAGES 14 AND 15

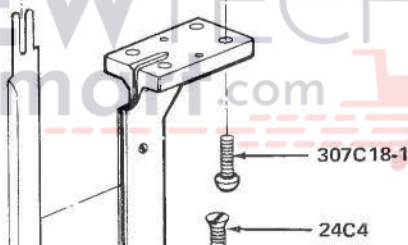

307C18-1

24C4

STANDARD and BASE PLATE ASSEMBLY SEE PAGES 22 AND 23

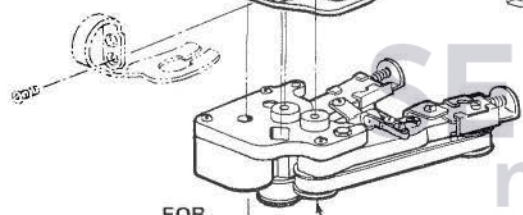

FOR REPLACEMENT BELTS SEE PAGE 4

LOWER GEAR BRACKET ASSEMBLY SEE PAGES 20 AND 21

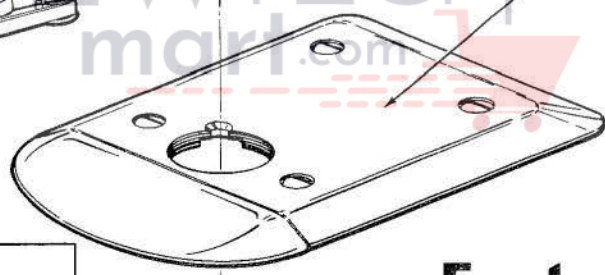

4C2-2

Eastmanmachine COMPANY 779 WASHINGTON STREET BUFFALO, NEW YORK 14203

Eastmanmachine COMPANY

779 WASHINGTON STREET
BUFFALO, NEW YORK 14203

SINGLE PHASE MOTOR ASSEMBLIES

(SINGLE AND DUAL SPEED)

PLEASE SPECIFY
MACHINE CLASS NUMBER
AND SERIAL NUMBER
WHEN ORDERING PARTS

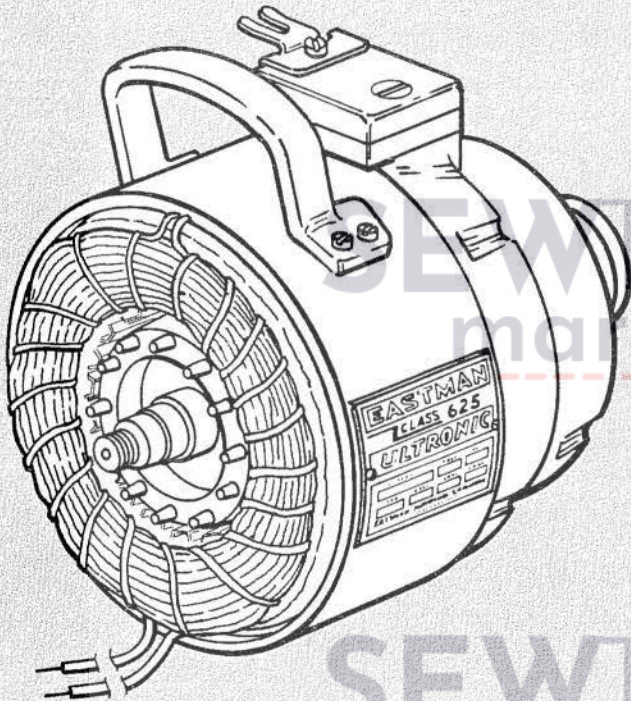

Part No.	Description
4C1-145	SHAFT LOCK NUT
4C2-87	CLUTCH NUT
8C12-4	LEAD WIRE INSULATION (2 Req'd.)
10C1-41	ROTOR FAN
12C1-12	LOADING SPRING WASHER
13C1-9	TURNING KNOB
18C6-16	RETAINING RING
20C12-2	TERMINAL SCREW (2 Req'd.)
22C1-24	CARRYING HANDLE
30C1-8	COVER FOR CUTOUT
34C1-51	CLUTCH SPRING
47C2-4	TERMINAL PIN (2 Req'd.)
51C1-16	TERMINAL BLOCK (Top)
51C1-17	TERMINAL BLOCK (Bottom)
53C7-35	FAN COVER
67C1-10	CUTOUT SWITCH MOUNT
73C7-121	TUBING FOR LEAD WIRES
79C12-107	GROUND CLIP
90C1-146	REAR BEARING HOUSING
90C6-28	REAR BALL BEARING
93C2-1	TERMINAL CONTACT (2 Req'd.)
300C12-5	SCREW, 8-32 x 7/16 ROUND HD. (2 Req'd.)
300C12-7	SCREW, 8-32 x 5/8 ROUND HD. (4 Req'd.)
301C8-1	SCREW, 4-40 x 1/2 FILLISTER HD. (3 Req'd.)
301C15-5	SCREW, 10-32 x 7/8 FILLISTER HD. (1 Req'd.)
302C15-6	SCREW, 10-32 x 7/8 FLAT HD. (1 Req'd.)
305C8-1	SCREW, 4-40 x 1/4 BINDING HD. (3 Req'd.)
508C1-19	TERMINAL BLOCK (Complete)
513C3-206	ROTOR WITH SHAFT
514C3-64	STATOR WITH BAND 110V. 50cy. 3000 R.P.M.
514C3-65	STATOR WITH BAND 110V. 50cy. 1500 R.P.M.
514C3-67	STATOR WITH BAND 110V. 60cy. 3600 R.P.M.
514C3-68	STATOR WITH BAND 110V. 60cy. 1800 R.P.M.
514C3-73	STATOR WITH BAND 220V. 50cy. 3000 R.P.M.
514C3-74	STATOR WITH BAND 220V. 50cy. 1500 R.P.M.
514C3-76	STATOR WITH BAND 220V. 60cy. 3600 R.P.M.
514C3-77	STATOR WITH BAND 220V. 60cy. 1800 R.P.M.
514C3-72	STATOR WITH BAND 150V. 60cy. 3600 R.P.M.
514C3-85	STATOR WITH BAND 250V. 50cy. 3000 R.P.M.
514C3-66	STATOR WITH BAND 110V. 50cy. 1500/3000 R.P.M.
514C3-69	STATOR WITH BAND 110V. 60cy. 1800/3600 R.P.M.
514C3-75	STATOR WITH BAND 220V. 50cy. 1500/3000 R.P.M.
514C3-78	STATOR WITH BAND 220V. 60cy. 1800/3600 R.P.M.
523C1-51	ATTACHMENT PLUG (Complete)
580C1-66	AUTOMATIC CUTOUT SWITCH-DUAL SPEED
580C1-70	AUTOMATIC CUTOUT SWITCH-SINGLE SPEED
597C2-14	AUTOMATIC CUTOUT 60cy. 3600 R.P.M.
597C2-15	AUTOMATIC CUTOUT 50cy. 3000 R.P.M.
597C2-16	AUTOMATIC CUTOUT 60cy. 1800 R.P.M.
597C2-17	AUTOMATIC CUTOUT 50cy. 1500 R.P.M.
597C2-15	AUTOMATIC CUTOUT 60cy. 1800/3600 R.P.M.
597C2-18	AUTOMATIC CUTOUT 50cy. 1500/3000 R.P.M.
615C1-7	ATTACHMENT PLUG CLAMP
667C1	TERMINAL CONTACT WITH PIN (2 Req'd.)
667C2	TERMINAL SLEEVE WITH CLIP (2 Req'd.)

SINGLE PHASE—SINGLE SPEED

- 514C3-64 110 V. 50 CY. 3000 R.P.M.
- 514C3-65 110 V. 50 CY. 1500 R.P.M.
- 514C3-67 110 V. 60 CY. 3600 R.P.M.
- 514C3-68 110 V. 60 CY. 1800 R.P.M.
- 514C3-73 220 V. 50 CY. 3000 R.P.M.
- 514C3-74 220 V. 50 CY. 1500 R.P.M.
- 514C3-76 220 V. 60 CY. 3600 R.P.M.
- 514C3-77 220 V. 60 CY. 1800 R.P.M.
- 514C3-72 150 V. 60 CY. 3600 R.P.M.
- 514C3-85 250 V. 50 CY. 3000 R.P.M.

SINGLE PHASE—DUAL SPEED

- 514C3-66 110 V. 50 CY. 1500/3000 R.P.M.
- 514C3-69 110 V. 60 CY. 1800/3600 R.P.M.
- 514C3-75 220 V. 50 CY. 1500/3000 R.P.M.
- 514C3-78 220 V. 60 CY. 1800/3600 R.P.M.

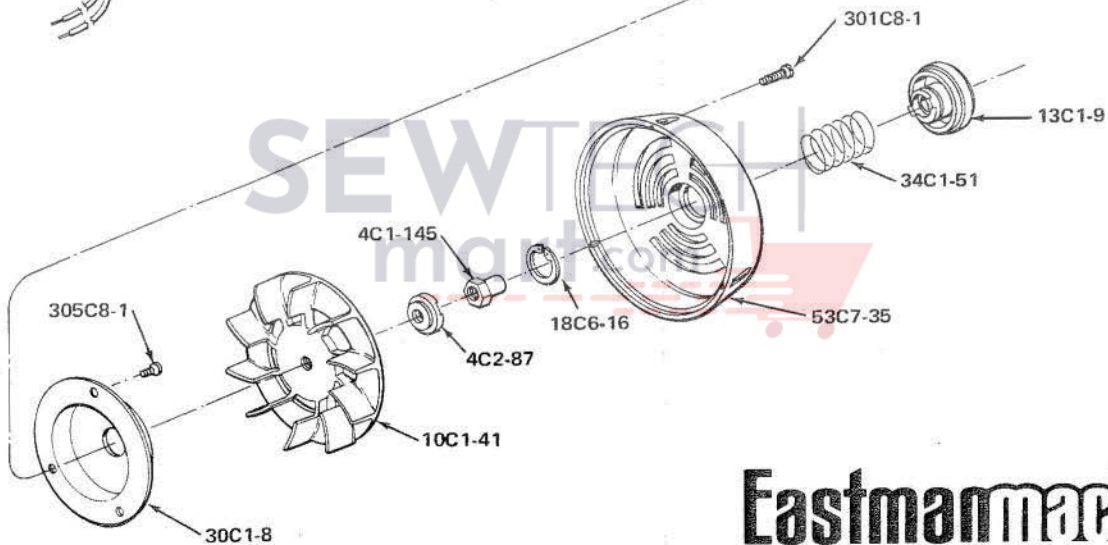
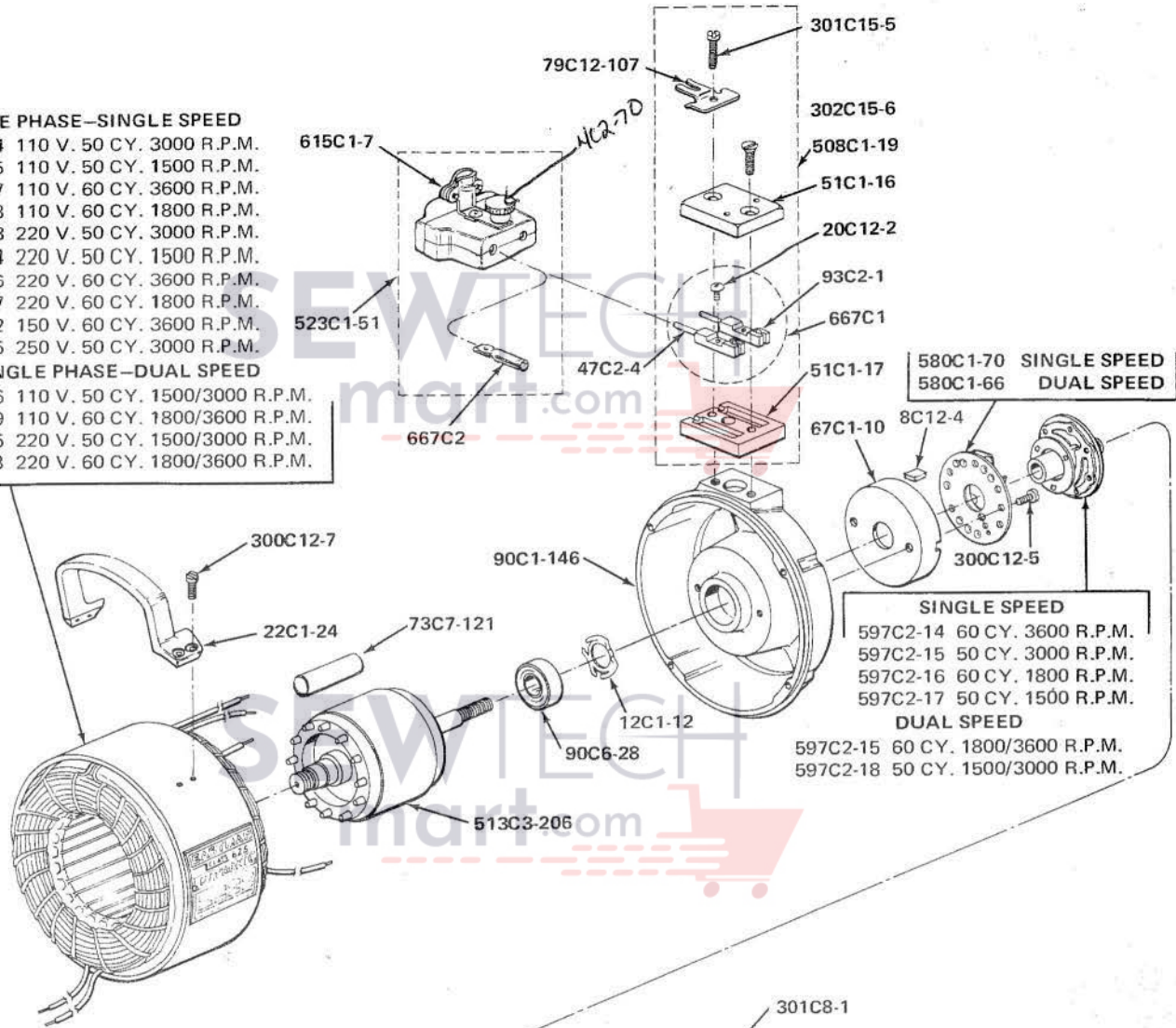

Eastmanmachine
COMPANY

778 WASHINGTON STREET
 BUFFALO, NEW YORK 14203

SEWTECH
mart.com

PLEASE SPECIFY
MACHINE CLASS NUMBER
AND SERIAL NUMBER
WHEN ORDERING PARTS

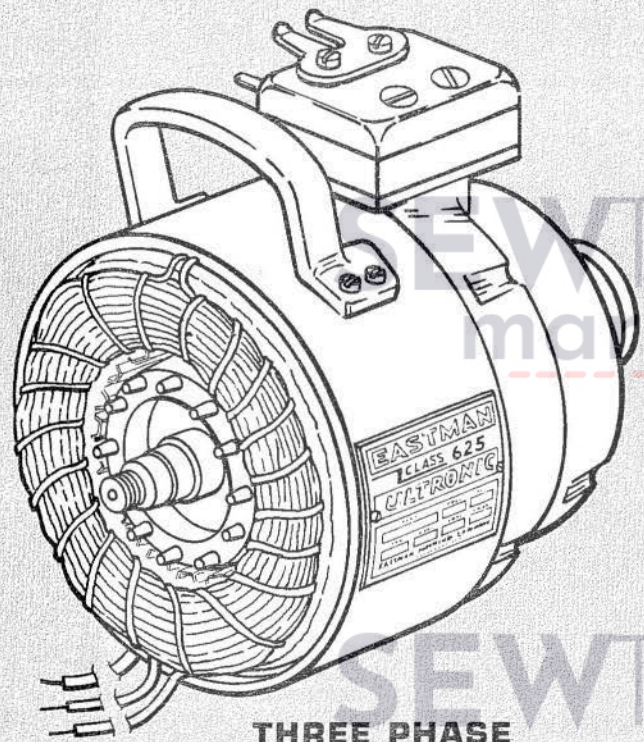

**THREE PHASE
MOTOR
ASSEMBLIES**

(SINGLE AND DUAL SPEED)

**Eastmanmachine
COMPANY**

779 WASHINGTON STREET
BUFFALO, NEW YORK 14203

Part No.	Description
1C4-8	SPACING SLEEVE
4C1-145	SHAFT LOCK NUT
4C2-87	CLUTCH NUT
10C1-41	ROTOR FAN
12C1-12	LOADING SPRING WASHER
13C1-9	TURNING KNOB
18C6-16	RETAINING RING
22C1-24	CARRYING HANDLE
29C6-67	TERMINAL BLOCK ADAPTER
34C1-51	CLUTCH SPRING
47C2-9	TERMINAL PIN (3 Req'd.)
47C3-17	TERMINAL SLEEVE (3 Req'd.)
51C1-18	TERMINAL BLOCK (Top)
51C1-19	TERMINAL BLOCK (Bottom)
53C7-35	FAN COVER
73C7-121	TUBING FOR LEAD WIRES
79C12-106	GROUND CLIP
90C1-146	REAR BEARING HOUSING
90C6-28	REAR BALL BEARING
300C12-3	SCREW, 8-32 x 3/8 ROUND HD. (2 Req'd.)
300C12-7	SCREW, 8-32 x 5/8 ROUND HD. (4 Req'd.)
301C8-1	SCREW, 4-40 x 1/2 FILLISTER HD. (3 Req'd.)
301C15-9	SCREW, 10-32 x 1 1/2 FILLISTER HD. (1 Req'd.)
301C15-12	SCREW, 10-32 x 1 1/8 FILLISTER HD. (1 Req'd.)
302C15-7	SCREW, 10-32 x 1 FLAT HD. (1 Req'd.)
302C15-11	SCREW, 10-32 x 1 1/2 FLAT HD. (1 Req'd.)
508C1-22	TERMINAL BLOCK (Complete)
513C3-206	ROTOR WITH SHAFT
514C3-79	STATOR WITH BAND 220V, 50cy. 3000 R.P.M.
514C3-80	STATOR WITH BAND 220V, 50cy. 1500 R.P.M.
514C3-81	STATOR WITH BAND 208V, 60cy. 3600 R.P.M.
514C3-82	STATOR WITH BAND 220V, 60cy. 3600 R.P.M.
514C3-83	STATOR WITH BAND 220V, 60cy. 1800 R.P.M.
514C3-84	STATOR WITH BAND 220V, 60cy. 1800/3600 R.P.M.
514C3-98	STATOR WITH BAND 220V, 50cy. 1500/3000 R.P.M.
523C1-38	ATTACHMENT PLUG (Complete)
615C1-5	ATTACHMENT PLUG CLAMP
667C1-1	CONTACT WITH PIN (3 Req'd.)

SEWTECH
mart.com

THREE PHASE-SINGLE SPEED

- 514C3-79 220 V. 50 CY. 3000 R.P.M.
- 514C3-80 220 V. 50 CY. 1500 R.P.M.
- 514C3-81 208 V. 60 CY. 3600 R.P.M.
- 514C3-82 220 V. 60 CY. 3600 R.P.M.
- 514C3-83 220 V. 60 CY. 1800 R.P.M.

THREE PHASE-DUAL SPEED

- 514C3-84 220 V. 60 CY. 1800/3600 R.P.M.
- 514C3-98 220 V. 50 CY. 1500/3000 R.P.M.

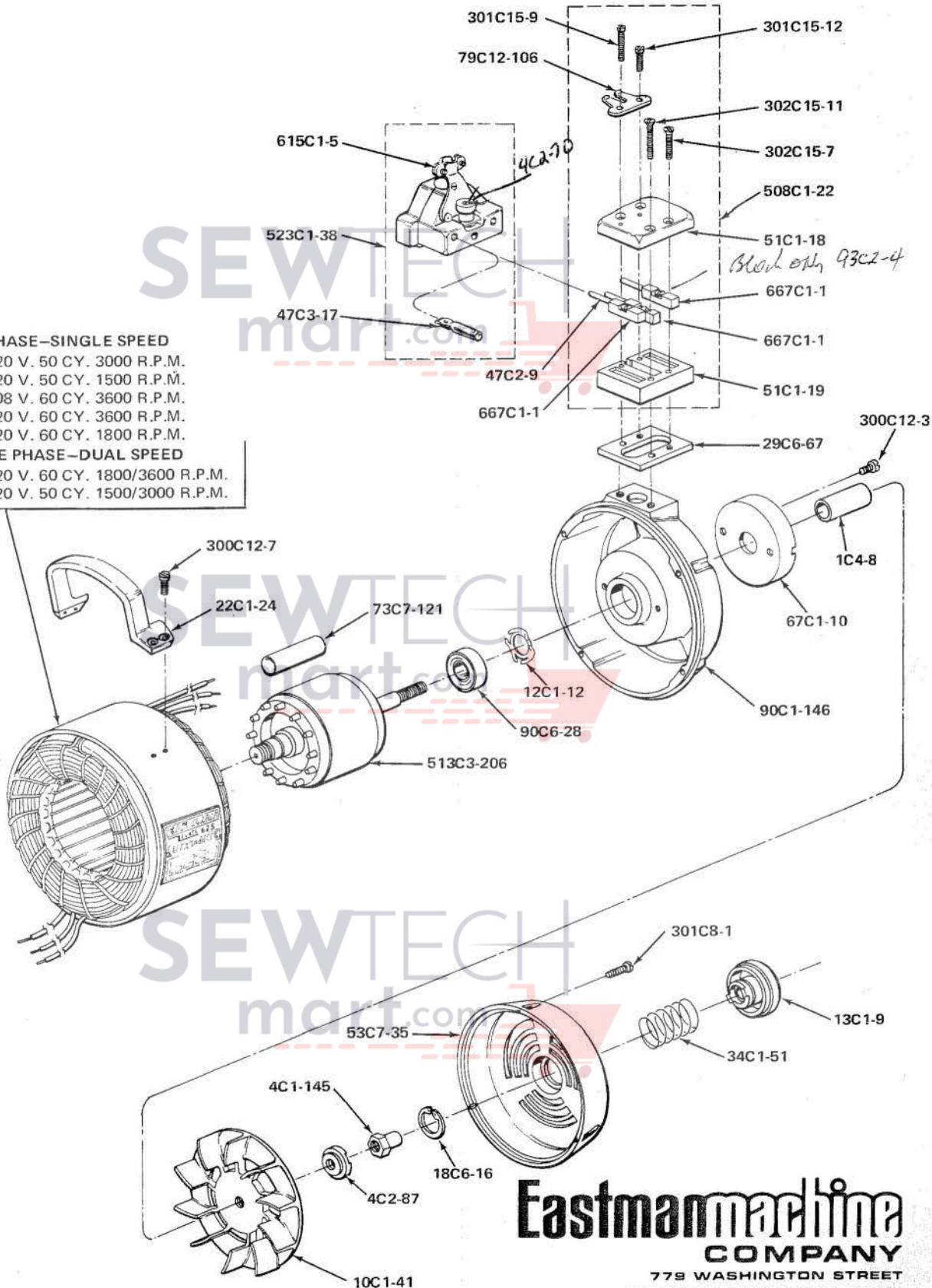

Eastman machine
COMPANY
779 WASHINGTON STREET
BUFFALO, NEW YORK 14203

Eastmanmachine COMPANY

779 WASHINGTON STREET
BUFFALO, NEW YORK 14203

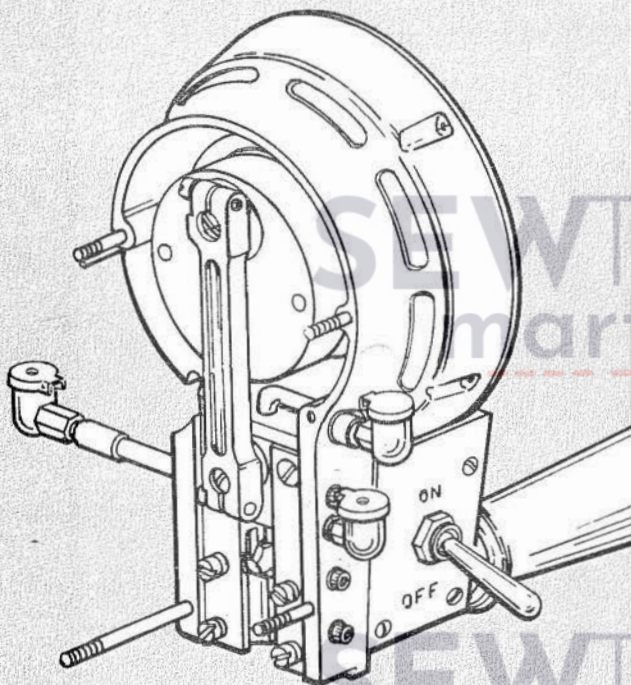

FRONT BEARING HOUSING ASSEMBLY

PLEASE SPECIFY
MACHINE CLASS NUMBER
AND SERIAL NUMBER
WHEN ORDERING PARTS

Part No.	Description
4C1-111	OPERATING HANDLE LOCK NUT
4C1-132	CRANK BALL BEARING LOCK NUT
4C1-190	LOCK NUT FOR SHAFT
4C2-91	NUT FOR GUIDE SCREW (3 Req'd.)
4C2-110	STOP NUT
4C3-8	GUIDE ADJUSTMENT NUT (3 Req'd.)
8C4-37	SWITCH INSULATION
11C12-92	SHAFT FOR BALL BEARING
12C1-21	SHAKEPROOF WASHER (2 Req'd.)
12C1-24	KNIFE LOCK WASHER
12C15-14	GUIDE WASHER (4 Req'd.)
12C15-53	CONNECTING ROD WASHER
15C13-23	STUD, UPPER (2 Req'd.)
15C13-34	STUD, LOWER L.H. MOUNTING
15C13-39	STUD, LOWER R.H. MOUNTING
17C4-6	WRIST PIN
20C5-17	CONNECTING ROD CLAMP SCREW (2 Req'd.)
20C12-62	FRONT HOUSING PLUG SCREW
20C12-79	SCREW FOR HANDLE BRACKET
20C12-122	GUIDE HOLD DOWN SCREW (2 Req'd.)
20C12-123	GUIDE HOLD DOWN SCREW (4 Req'd.)
20C13-4	SET SCREW
20C13-14	GUIDE LOCK SCREW (3 Req'd.)
20C13-15	GUIDE ADJUSTMENT SCREW (3 Req'd.)
24C1-3	KNIFE LOCK BOLT
34C10-142	SPRING FOR CAPACITOR
52C5-161	SWITCH BASE - SINGLE SPEED 1 & 3 PHASE
52C5-163	SWITCH BASE - DUAL SPEED 3 PHASE
52C5-162	SWITCH BASE - DUAL SPEED 1 PHASE
53C2-98	SWITCH COVER
53C11-91	CAPACITOR COVER
54C4-32	WRIST PIN PLUG
62C1-140	HANDLE BRACKET
70C1-71	R.H. GUIDE 1-1/8 STROKE
70C1-69	R.H. GUIDE 1-1/4 STROKE
70C1-67	R.H. GUIDE 1-1/2 STROKE
70C1-66	R.H. GUIDE 1-3/4 STROKE
70C1-72	L.H. GUIDE 1-1/8 STROKE
70C1-70	L.H. GUIDE 1-1/4 STROKE
70C1-68	L.H. GUIDE 1-1/2 STROKE
70C1-65	L.H. GUIDE 1-3/4 STROKE
71C3-18	FRONT BALL BEARING RETAINER
72C4-15	OIL CUP (1 Req'd.)
72C4-26	OIL CUP (2 Req'd.)
73C1-7	OIL TUBE, L.H. GUIDE
73C1-9	OIL TUBE, R.H. GUIDE
73C6-24	OIL TUBE FOR WRIST PIN
73C7-69	OIL TUBE FOR WRIST PIN
85C1-52	CRANK 1-1/8 STROKE
85C1-46	CRANK 1-1/4 STROKE
85C1-45	CRANK 1-1/2 STROKE
85C1-44	CRANK 1-3/4 STROKE
90C2-139	FRONT BEARING HOUSING
90C6	CRANK BALL BEARING
90C6-38	FRONT BALL BEARING
300C10-4	SCREW, 6-32 x 3/8 ROUND HD. (2 Req'd.)
300C12-3	SCREW, 8-32 x 3/8 ROUND HD. (1 Req'd.)
302C10-4	SCREW, 6-32 x 5/16 FLAT HD. (4 Req'd.)
305C8-1	SCREW, 4-40 x 1/4 BINDING HD. (9 Req'd.)
307C18-1	BUTTON HD. SCREW
531C1-53	OPERATING HANDLE
579C2-17	CROSS HEAD (With Lock Washer & Bolt)
580C1-52	SWITCH - DUAL SPEED 3 PHASE
580C1-65	SWITCH - SINGLE SPEED 3 PHASE
580C1-81	SWITCH - DUAL SPEED 1 PHASE
580C1-85	SWITCH, SINGLE SPEED 1 PHASE
664C1-6	CONNECTING ROD 1-1/8 STROKE
664C1-5	CONNECTING ROD 1-1/4 STROKE
664C1-4	CONNECTING ROD 1-1/2 STROKE
664C1-3	CONNECTING ROD 1-3/4 STROKE
706C1-4	CAPACITOR 110 VOLT
706C1-5	CAPACITOR 220 VOLT
727C1-5	OIL PAD HOLDER 1-1/8 - 1-1/4 - 1-1/2 STROKE
727C1-8	OIL PAD HOLDER 1-3/4 STROKE

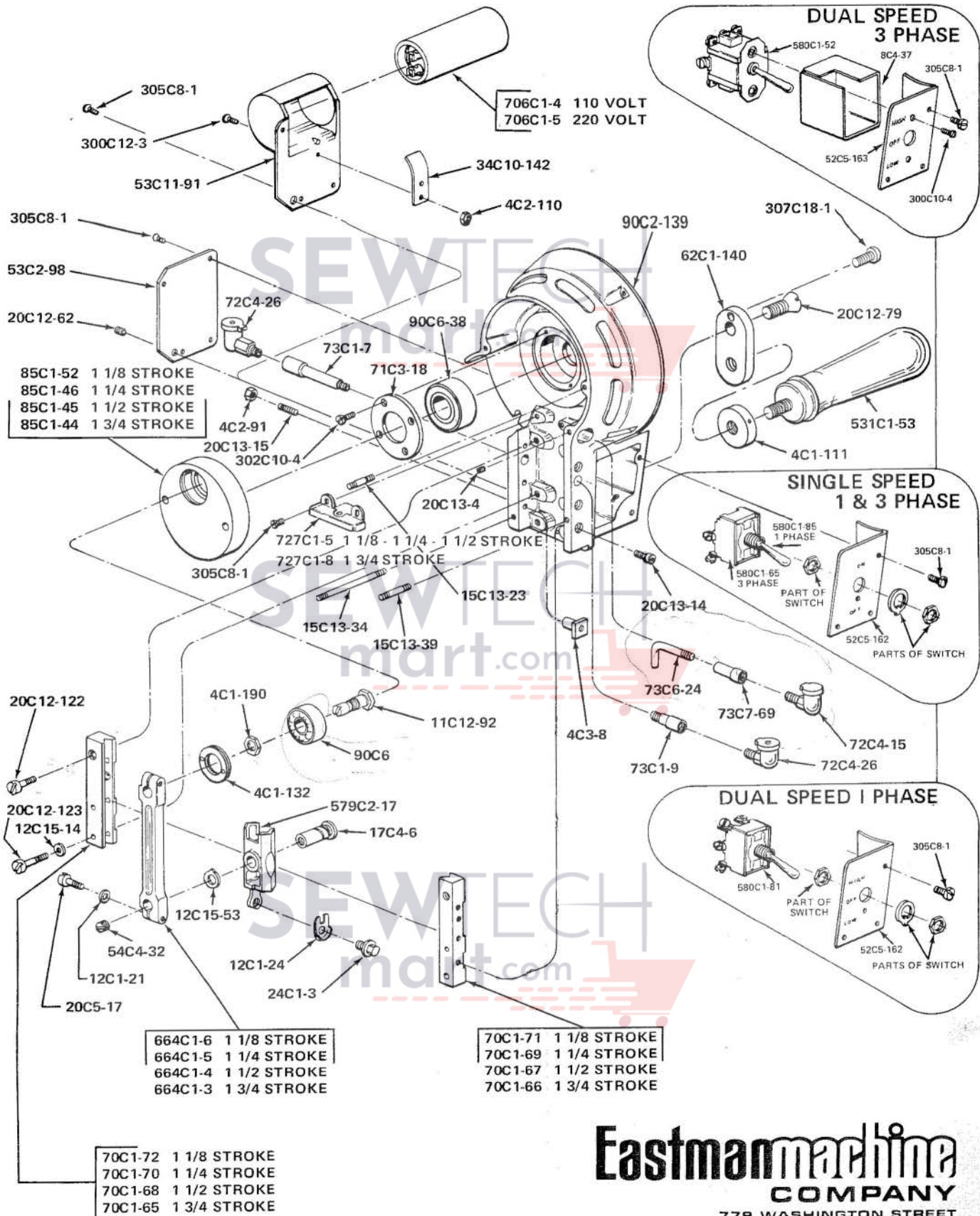

Eastman machine
COMPANY
779 WASHINGTON STREET
BUFFALO, NEW YORK 14203

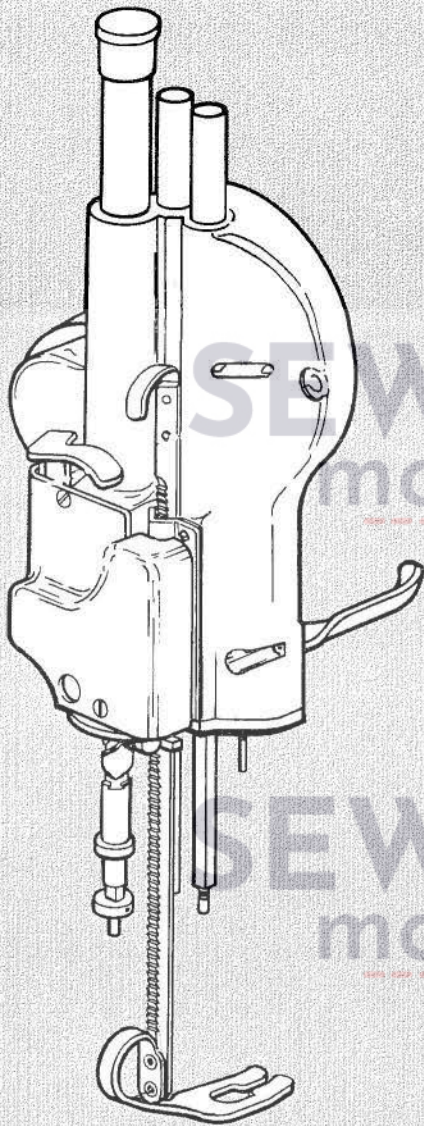

PLEASE SPECIFY
MACHINE CLASS NUMBER
AND SERIAL NUMBER
WHEN ORDERING PARTS

SHARPENER HOUSING ASSEMBLY

(FRONT VIEW)

Eastmanmachine COMPANY

779 WASHINGTON STREET
BUFFALO, NEW YORK 14203

Part No.	Description
4C1-149	STOP NUT FOR SCREW SHAFT
4C1-161	NUT FOR PRESSURE FOOT LOCK
4C2-112	R.H. NUT FOR SCREW SHAFT
4C2-113	L.H. NUT FOR SCREW SHAFT
5C5-16	COLLAR FOR EXTENSION
11C12-54	SHAFT FOR CAM
11C12-67	SCREW SHAFT 5" - 8" KNIFE
11C12-68	SCREW SHAFT 9" - 10" KNIFE
11C12-82	SCREW SHAFT 11½" - KNIFE
11C12-86	SCREW SHAFT 13" KNIFE
12C15-57	SPRING WASHER FOR RELEASE LEVER
12C15-69	WASHER FOR LOCK BRACKET
12C15-74	THRUST WASHER FOR NUTS (4 Req'd.)
12C15-91	THRUST WASHER - UPPER NUT (2 Req'd.)
17C15-106	ROLL PIN FOR COLLAR
20C4-17	PRESSURE FOOT LEVER SCREW
20C12-13	CAM SHAFT SPRING SCREW
20C12-113	SCREW FOR LATCH
20C12-117	SCREW FOR PRESSURE FOOT SHOE (2 Req'd.)
20C12-119	SCREW FOR RELEASE LEVER
20C12-137	SCREW FOR PRESSURE FOOT LOCK
22C3-2	LIFT HANDLE FOR PRESSURE FOOT ROD
34C1-20	CAM SPRING
34C8-12	SPRING FOR PRESSURE FOOT LOCK
34C10-100	SPRING FOR PRESSURE FOOT LEVER 5" - 13" KNIFE
34C10-107	SPRING FOR LATCH
53C11-72	COVER OVER CAM
55C4-49	SPACER FOR PRESSURE FOOT LOCK BRACKET
57C7-39	PRESSURE FOOT LEVER 5" - 13" KNIFE
66C1-54	SLIDE FOR PRESSURE FOOT ROD
68C1-192	PRESSURE FOOT SHOE, ALL STROKES
71C3-15	THRUST BALL BEARING (3 Req'd.)
86C7-34	CAP FOR TUBE
90C4-47	BEARING FOR CAM SHAFT (2 Req'd.)
97C3-35	LATCH FOR CAM
147C1-26	EXTENSION FOR SCREW SHAFT
171C1-16	LOCK (Only) FOR PRESSURE FOOT
300C10-1	SCREW, 6-32 x 3/16 ROUND HD. (2 Req'd.)
300C10-4	SCREW, 6-32 x 3/8 ROUND HD. (4 Req'd.)
302C10-4	SCREW, 6-32 x 5/16 FLAT HD. (1 Req'd.)
302C10-8	SCREW, 6-32 x 3/4 FLAT HD. (1 Req'd.)
309C15-7	SET SCREW FOR CAM
553C1-7	PRESSURE FOOT LOCK BRACKET COMPLETE
553C1-8	PRESSURE FOOT LOCK BRACKET ONLY
605C1-35	PRESSURE FOOT ROD 5" - 6" KNIFE
605C1-36	PRESSURE FOOT ROD 7" - 8" KNIFE
605C1-37	PRESSURE FOOT ROD 9" - 10" KNIFE
605C1-33	PRESSURE FOOT ROD 11½" KNIFE
605C1-34	PRESSURE FOOT ROD 13" KNIFE
621C1-7	RELEASE LEVER WITH CAM
713C4-4	SCREW SHAFT WITH EXTENSION, R. & L. HAND NUTS 5" - 8"
713C4-5	SCREW SHAFT WITH EXTENSION, R. & L. HAND NUTS 9" - 10"
713C4-6	SCREW SHAFT WITH EXTENSION, R. & L. HAND NUTS 11½"
713C4-7	SCREW SHAFT WITH EXTENSION, R. & L. HAND NUTS 13"
732C1-11	SHARPENER HOUSING (With bushings and tubes) ONLY 5" - 8" KNIFE
732C1-12	SHARPENER HOUSING (With bushings and tubes) ONLY 9" - 10" KNIFE
732C1-20	SHARPENER HOUSING (With bushings and tubes) ONLY 11½" KNIFE
732C1-17	SHARPENER HOUSING (With bushings and tubes) ONLY 13" KNIFE

* THESE PARTS SOLD ONLY IN ASSEMBLYS AS FOLLOWS.

- 713C4-4 Screw Shaft with extension, R. & L. Hand Nuts 5" - 8"
- 713C4-5 Screw Shaft with extension, R. & L. Hand Nuts 9" - 10"
- 713C4-6 Screw Shaft with extension, R. & L. Hand Nuts 11½"
- 713C4-7 Screw Shaft with extension, R. & L. Hand Nuts 13"

FOR
SPACER
CHART
(SEE
SHARPENER
HOUSING
ASSEMBLY
DRAWING)
(REAR VIEW)
PAGE 19

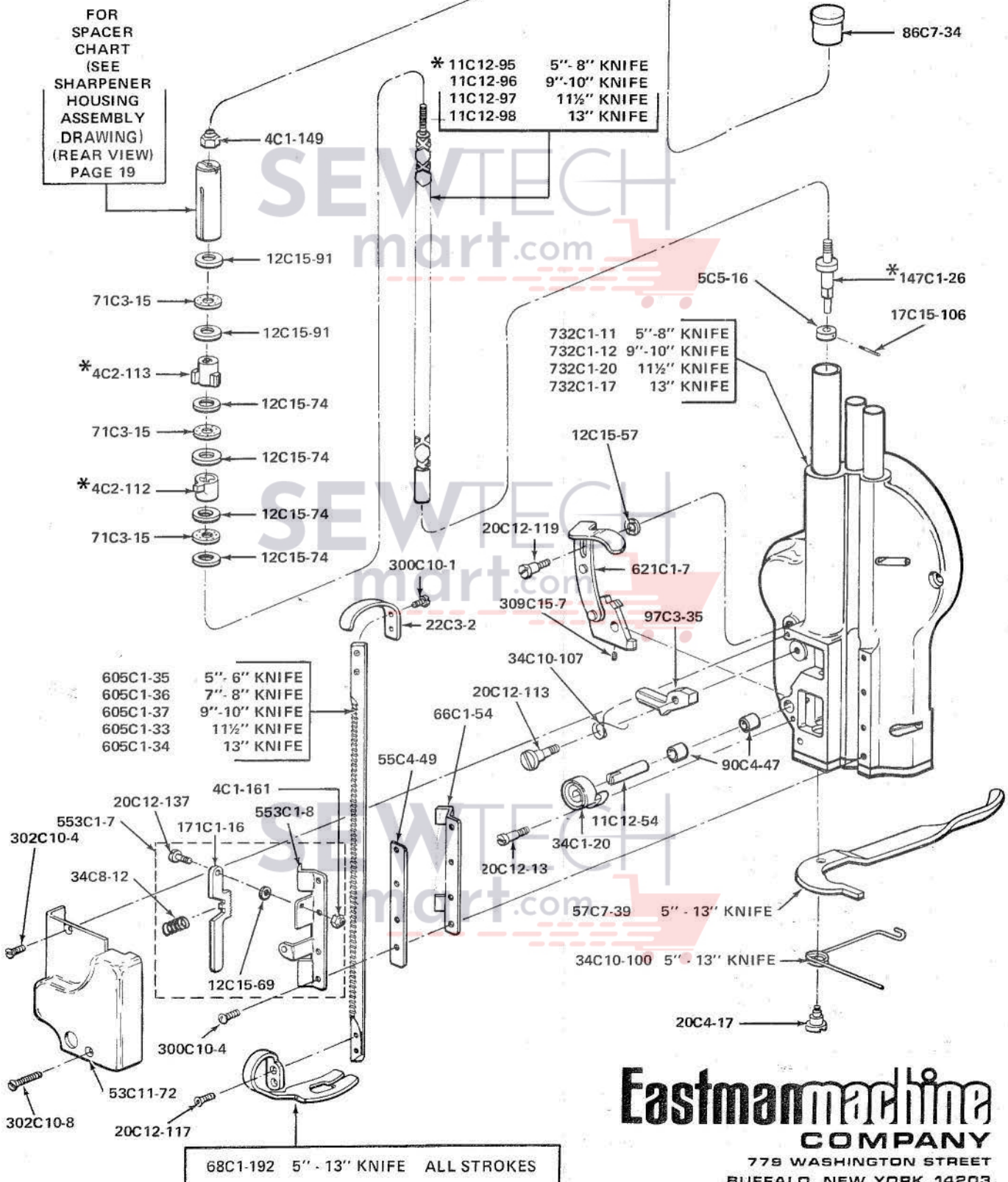

Eastmanmachine
COMPANY
779 WASHINGTON STREET
BUFFALO, NEW YORK 14203

Eastmanmachine COMPANY

779 WASHINGTON STREET
BUFFALO, NEW YORK 14203

SHARPENER HOUSING ASSEMBLY (REAR VIEW)

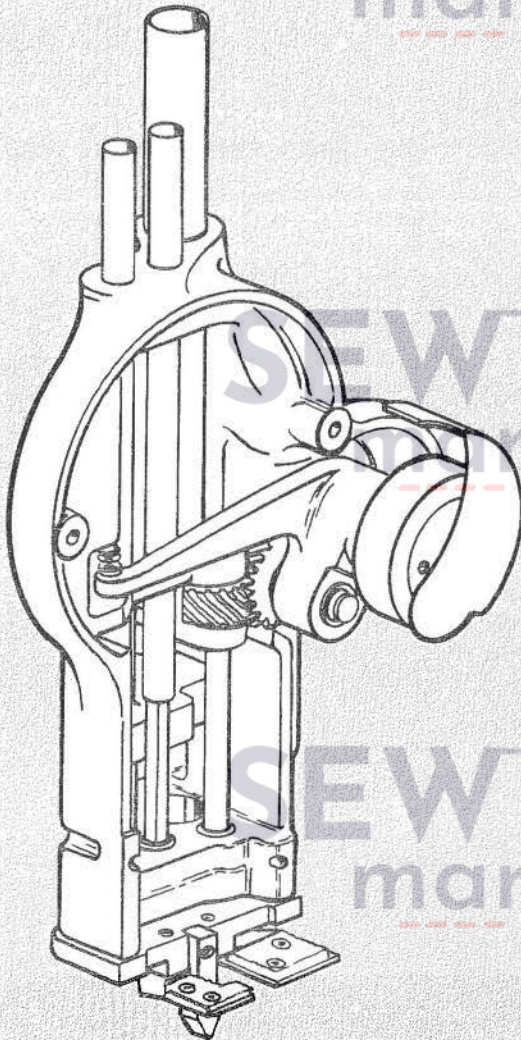

PLEASE SPECIFY
MACHINE CLASS NUMBER
AND SERIAL NUMBER
WHEN ORDERING PARTS

Part No.	Description
4C2-2	LOCK NUT FOR SHAFT
4C2-85	R.H. FOLLOWER NUT
4C2-86	L.H. FOLLOWER NUT
11C12-58	R.H. SQUARE SHAFT 5" - 8" KNIFE
11C12-59	R.H. SQUARE SHAFT 9" - 10" KNIFE
11C12-81	R.H. SQUARE SHAFT 11½" KNIFE
11C12-85	R.H. SQUARE SHAFT 13" KNIFE
11C12-56	L.H. SQUARE SHAFT 5" - 8" KNIFE
11C12-57	L.H. SQUARE SHAFT 9" - 10" KNIFE
11C12-80	L.H. SQUARE SHAFT 11½" KNIFE
11C12-84	L.H. SQUARE SHAFT 13" KNIFE
11C12-64	SHAFT FOR CRANK
12C15-29	THRUST WASHER (2 Req'd.)
12C15-30	THRUST WASHER FOR BOTTOM PLATE (2 Req'd.)
12C15-52	WASHER FOR SHAFT
17C15-78	PIN FOR BELL CRANK
17C15-82	PIN FOR SHARPENER HOUSING
17C15-103	ROLL PIN FOR PUSH ROD
17C15-113	SPREADER PIN
18C6-8	RETAINING RING FOR SHAFT
18C6-26	RETAINING RING FOR BELL CRANK
34C10-89	SPRING FOR BELL CRANK
53C11-60	COVER FOR DRIVER
55C4-41	SPACER FOR BALL BEARINGS
57C7-46	RELEASE LEVER
62C16-151	SHARPENER HOUSING (Only)
65C6-75	PUSH ROD
73C7-46	TUBE FOR SQUARE SHAFTS 4" - 8" KNIFE
73C7-47	TUBE FOR SQUARE SHAFTS 9" - 10" KNIFE
73C7-86	TUBE FOR SQUARE SHAFTS 11½" KNIFE
73C7-88	TUBE FOR SQUARE SHAFTS 13" KNIFE
73C7-48	TUBE FOR SCREW SHAFT 4" - 8" KNIFE
73C7-49	TUBE FOR SCREW SHAFT 9" - 10" KNIFE
73C7-85	TUBE FOR SCREW SHAFT 11½" KNIFE
73C7-87	TUBE FOR SCREW SHAFT 13" KNIFE
79C12-163	BOTTOM PLATE
85C3-3	BELL CRANK (Only)
87C3-40	IDLER GEAR
87C3-44	SPUR GEAR (2 Req'd.)
87C3-53	GEAR AND SHAFT
90C4-29	BEARING FOR DRIVE SHAFT (Lower)
90C4-33	BEARING FOR GEARS (2 Req'd.)
90C4-34	BEARING FOR BELL CRANK
90C4-42	BEARING FOR DRIVE SHAFT
90C4-48	BEARING FOR DRIVE SHAFT (Upper)
90C4-58	BEARING FOR SCREW SHAFT
90C6-24	BALL BEARING FOR CRANK (2 Req'd.)
300C7-2	SCREW, 4-36 x 3/16 ROUND HD. (2 Req'd.)
300C10-1	SCREW, 6-32 x 3/16 ROUND HD. (2 Req'd.)
300C12-3	SCREW, 8-32 x 3/8 ROUND HD. (2 Req'd.)
302C10-6	SCREW, 6-32 x 1/2 FLAT HD. (1 Req'd.)
302C12-3	SCREW, 8-32 x 3/8 FLAT HD. (3 Req'd.)
584C2-3	BELL CRANK WITH PIN & BEARING (Only)
584C3-16	BELL CRANK COMPLETE WITH LEVER
602C1-9	DRIVER PULLEY WITH DRIVER
716C1-12	DRIVER SHAFT WITH GEAR
724C1-3	L.H. SPIRAL GEAR WITH KEY
727C1-6	OIL PAD & HOLDER

4C2-86

4C2-85

11C12-58 5"- 8" KNIFE
 11C12-59 9"-10" KNIFE
 11C12-81 11½" KNIFE
 11C12-85 13" KNIFE

73C7-46 4"- 8" KNIFE
 73C7-47 9"-10" KNIFE
 73C7-86 11½" KNIFE
 73C7-88 13" KNIFE

73C7-48 5"- 8" KNIFE
 73C7-49 9"-10" KNIFE
 73C7-85 11½" KNIFE
 73C7-87 13" KNIFE

11C12-56 5"- 8" KNIFE
 11C12-57 9"-10" KNIFE
 11C12-80 11½" KNIFE
 11C12-84 13" KNIFE

SPACER CHART
 For Automatic Sharpeners

STROKE	KNIFE SIZE	SPACER NUMBER	SPACER LENGTH
1 1/8 - 1 1/4	5	73C7-55	3 7/8
1 1/2 - 1 3/4	5	73C7-56	4 1/4
1 1/8 - 1 1/4	6	73C7-57	2 7/8
1 1/2 - 1 3/4	6	73C7-58	3 1/4
1 1/8 - 1 1/4	7	73C7-59	1 7/8
1 1/2 - 1 3/4	7	73C7-60	2 1/4
1 1/8 - 1 1/4	8	1C13-12	15/16
1 1/2 - 1 3/4	8	1C13-13	1 1/4
1 1/8 - 1 1/4	9	73C7-59	1 7/8
1 1/2 - 1 3/4	9	73C7-60	2 1/4
1 1/8 - 1 1/4	10	1C13-12	15/16
1 1/2 - 1 3/4	10	1C13-13	1 1/4
1 1/8 - 1 1/4	11 1/2	1C13-12	15/16
1 1/2 - 1 3/4	11 1/2	1C13-13	1 1/4
1 1/8 - 1 1/4	13	1C13-12	15/16
1 1/2 - 1 3/4	13	1C13-13	1 1/4

62C16-151

53C11-60

300C7-2

4C2-2

11C12-64

584C3-16 BELL CRANK COMPLETE WITH LEVER
 584C2-3 BELL CRANK WITH PIN & BRG. ONLY
 85C3-3 BELL CRANK ONLY

87C3-40

87C3-53

17C15-82

34C10-89

90C4-48

12C15-29

724C1-3

12C15-29

90C4-42

90C4-33

87C3-44

12C15-30

90C4-33

87C3-44

12C15-30

65C6-75

90C4-29

716C1-12

55C4-41

90C6-24

90C6-24

18C6-26

602C1-9

17C15-78

90C4-34

18C6-8

12C15-52

90C4-58

17C15-103

79C12-163

302C12-3

727C1-6

300C10-1

302C10-6

17C15-113

300C12-3

57C7-46

Eastmanmachine
COMPANY

779 WASHINGTON STREET
 BUFFALO, NEW YORK 14203

PLEASE SPECIFY
MACHINE CLASS NUMBER
AND SERIAL NUMBER
WHEN ORDERING PARTS

LOWER GEAR BRACKET ASSEMBLY

EASTMAN'S NEW PRE-SET SHARPENER
SHOES ILLUSTRATED
PATENT PENDING
FOR OPTIONAL BEVEL BLOC® SHOES
SEE LAST PAGE

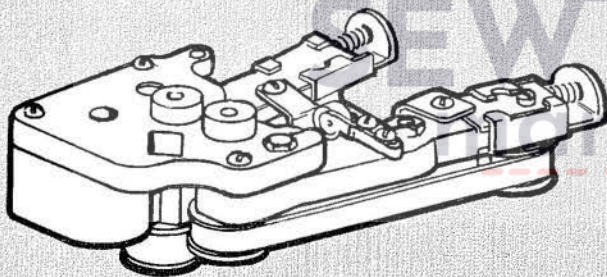

Eastmanmachine
COMPANY

778 WASHINGTON STREET
BUFFALO, NEW YORK 14203

Part No.	Description
715C1-22	LOWER GEAR BRACKET (Complete) 5" - 10 KNIFE
715C1-23	LOWER GEAR BRACKET (Complete) 11½" - 13" KNIFE
4C1-189	JAM NUT
4C2-63	NUT FOR SHARPENER SHOE SCREW (2 Req'd.)
12C15-94	THREADED WASHER (2 Req'd.)
17C15-106	ROLL PIN (For Pulley 152C1-19) (2 Req'd.)
20C6-25	ADJUSTING SCREW
20C12-57	SCREW FOR SHARPENER SHOE (Wave knife only) (2 Req'd.)
20C12-143	SCREW FOR CLAMPING ARM
20C12-153	SCREW FOR SHARPENER SHOE (2 Req'd.)
21C13-17	BUSHING FOR SHARPENER SHOE (2 Req'd.)
34C10-45	SPRING FOR PULLEY SLIDE (2 Req'd.)
34C10-47	L.H. SHARPENER SHOE SPRING (Wave knife only)
34C10-57	R.H. SHARPENER SHOE SPRING (Wave knife only)
34C10-123	SPRING FOR ARM
34C10-148	L.H. SHARPENER SHOE SPRING
34C10-149	R.H. SHARPENER SHOE SPRING
35C7-28	CLAMPING ARM FOR SHOE
53C4-78	GEAR COVER
54C4-35	GREASE PLUG
70C4-32	GUIDE BACK OF STANDARD
79C12-218	WEAR PLATE 5" - 10" KNIFE (2 Req'd.)
79C12-219	WEAR PLATE 11½" - 13" KNIFE (2 Req'd.)
87C3-50	GEAR ON SCREW SHAFT
87C5-13	INTERMEDIATE GEAR
90C4-47	BEARING FOR INTERMEDIATE GEAR
90C4-51	BEARING FOR SCREW SHAFT
90C4-59	BEARING FOR SHAFT EXTENSION (2 Req'd.)
147C1-28	R.H. SHAFT EXTENSION
147C1-29	L.H. SHAFT EXTENSION
152C1-19	FRONT PULLEY FOR BELT (2 Req'd.)
209C1	NEOPRENE BAND FOR PULLEY (2 Req'd.)
300C7-3	SCREW, 4-36 x 1/4 ROUND HD. (4 Req'd.)
300C10-2	SCREW, 6-32 x 1/4 ROUND HD. (2 Req'd.)
300C10-6	SCREW, 6-32 x 1/2 ROUND HD. (3 Req'd.)
301C7-2	SCREW, 4-36 x 3/16 FILLISTER HD. (2 Req'd.)
301C10-3	SCREW, 6-32 x 3/8 FILLISTER HD. (1 Req'd.)
309C12-2	ADJUSTING SCREW, L.H. SHOE
712C1	R.H. SLIDE WITH PULLEY
712C1-1	L.H. SLIDE WITH PULLEY
715C1-19	LOWER GEAR BRACKET WITH COVER 5" - 10" KNIFE
715C1-20	LOWER GEAR BRACKET WITH COVER 11½" - 13" KNIFE
728C1-5	STABILIZER (2 Req'd.)
743C1-26	R.H. SHOE (Wave knife only)
743C1-27	L.H. SHOE (Wave knife only)
743C1-28	R.H. PRE-SET SHARPENER SHOE
743C1-29	L.H. PRE-SET SHARPENER SHOE

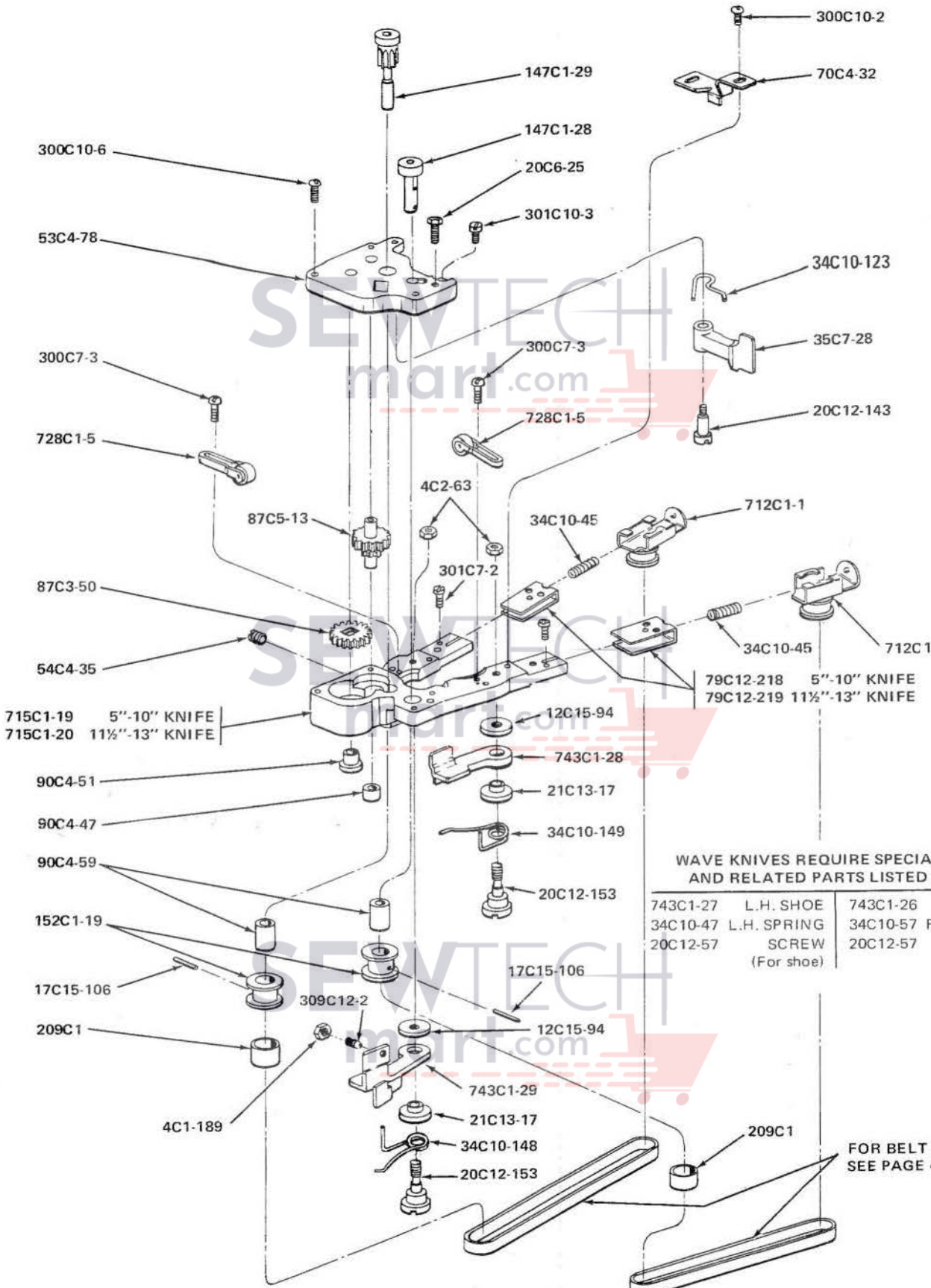

715C1-19 5"-10" KNIFE
 715C1-20 11½"-13" KNIFE

WAVE KNIVES REQUIRE SPECIAL SHOES AND RELATED PARTS LISTED BELOW

743C1-27	L.H. SHOE	743C1-26	R.H. SHOE
34C10-47	L.H. SPRING	34C10-57	R.H. SPRING
20C12-57	SCREW (For shoe)	20C12-57	SCREW (For shoe)

FOR BELT LISTING
 SEE PAGE 4

715C1-22 LOWER GEAR BRACKET COMPLETE FOR 5"-10" KNIFE
 715C1-23 LOWER GEAR BRACKET COMPLETE FOR 11½"-13" KNIFE

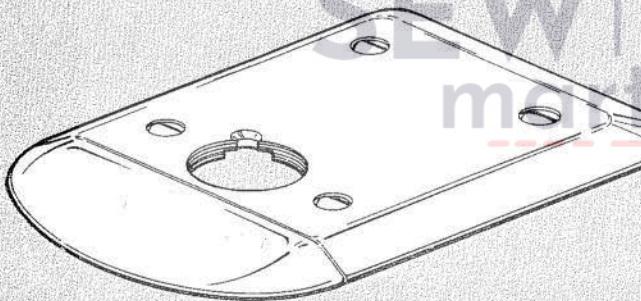
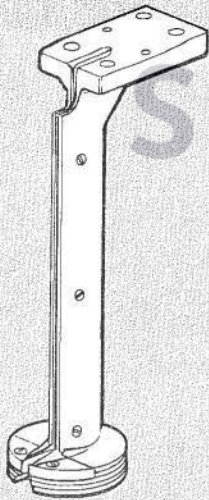

PLEASE SPECIFY
MACHINE CLASS NUMBER
AND SERIAL NUMBER
WHEN ORDERING PARTS

**STANDARD,
AND
BASE PLATE
ASSEMBLY**

**Eastmanmachine
COMPANY**

779 WASHINGTON STREET
BUFFALO, NEW YORK 14203

SEWTECH
mart.com

SEWTECH
mart.com

Part No.	Description
12C1-35	LOCK WASHER (4 Req'd.)
17C6-9	HINGE PIN (2 Req'd.)
20C5-12	CLAMP SCREW FOR ROLLERS (8 Req'd.)
20C12-19	KNIFE SLIDE SCREW
20C13-51	HINGE PIN CLAMP SCREW (4 Req'd.)
34C1-57	PLATE WING TENSION SPRING (2 Req'd.)
60C1-55	PLATE WING (For Small Plates)
60C1-56	PLATE WING (For Large Plates)
79C4-12/13	THROAT PLATES WITH SCREWS AND PINS
505C3-223	SMALL PLATE COMPLETE (5" - 10" KNIFE)
505C3-224	LARGE PLATE COMPLETE (11½" - 13" KNIFE)
505C3-226	SMALL PLATE COMPLETE (5" - 10" KNIFE) FOR 50 CY. 1500 R.P.M. & DUAL SPEED ONLY
505C3-227	LARGE PLATE COMPLETE (11½" - 13" KNIFE) FOR 50 CY. 1500 R.P.M. & DUAL SPEED ONLY
528C1-123	STANDARD (Complete with slides and throat plates) 5" KNIFE
528C1-120	STANDARD (Complete with slides and throat plates) 6" KNIFE
528C1-122	STANDARD (Complete with slides and throat plates) 7" KNIFE
528C1-121	STANDARD (Complete with slides and throat plates) 8" KNIFE
528C1-115	STANDARD (Complete with slides and throat plates) 9" KNIFE
528C1-116	STANDARD (Complete with slides and throat plates) 10" KNIFE
528C1-124	STANDARD (Complete with slides and throat plates) 11½" KNIFE
528C1-125	STANDARD (Complete with slides and throat plates) 13" KNIFE
532C2-5	RUBBER MOUNTED ROLLER (Complete) (4 Req'd.)
532C2-7	RUBBER MOUNTED ROLLER (Complete) (4 Req'd.)
619C1-31	ROLLER SHELL (Complete) (4 Req'd.)
643C1-44	KNIFE SLIDES (Complete with screws) 5" KNIFE
643C1-41	KNIFE SLIDES (Complete with screws) 6" KNIFE
643C1-42	KNIFE SLIDES (Complete with screws) 7" KNIFE
643C1-43	KNIFE SLIDES (Complete with screws) 8" KNIFE
643C1-46	KNIFE SLIDES (Complete with screws) 9" KNIFE
643C1-47	KNIFE SLIDES (Complete with screws) 10" KNIFE
643C1-53	KNIFE SLIDES (Complete with screws) 11½" KNIFE
643C1-45	KNIFE SLIDES (Complete with screws) 13" KNIFE

528C1-123	5" STANDARD
528C1-120	6" STANDARD
528C1-122	7" STANDARD
528C1-121	8" STANDARD
528C1-115	9" STANDARD
528C1-116	10" STANDARD
528C1-124	11½" STANDARD
528C1-125	13" STANDARD

INSTRUCTIONS FOR REMOVING WORN PLATE ROLLER SHELL

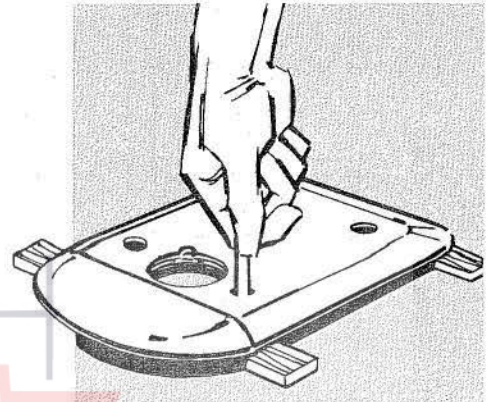

Place plate on blocks and press out roller shell from ring assembly, as shown.

Roller shell (complete with shaft and bearings) may be ordered as required – Specify Part No. 619C1-30.

Note: To install new plate roller shell reverse above procedure with base plate inverted.

KNIFE SLIDES

643C1-44	5" KNIFE
643C1-41	6" KNIFE
643C1-42	7" KNIFE
643C1-43	8" KNIFE
643C1-46	9" KNIFE
643C1-47	10" KNIFE
643C1-53	11½" KNIFE
643C1-45	13" KNIFE

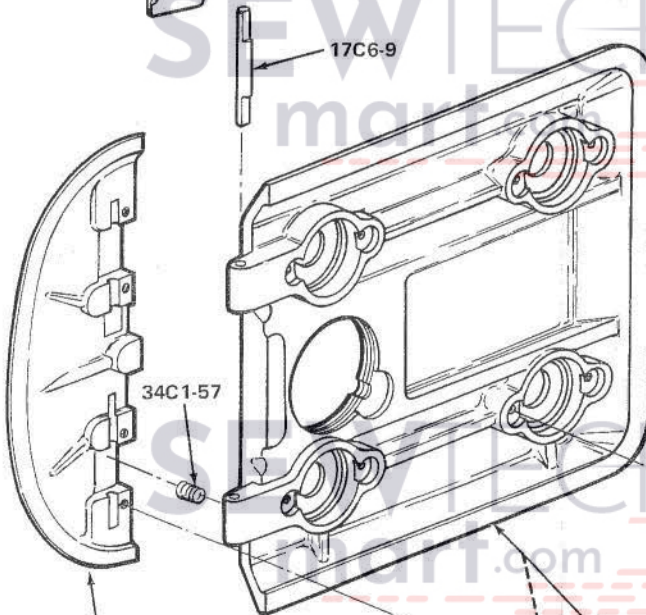
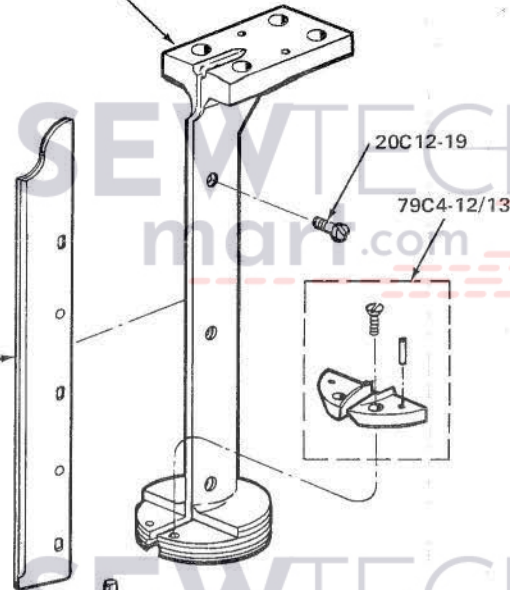

WARNING
Do not oil
plate roller shells.

532C2-5 RUBBER MOUNTED ROLLER
(For All Machines Except
Noted Below)

532C2-7 RUBBER MOUNTED ROLLER
(For 50 CY. 1500 R.P.M. and
Dual Speed Machines Only)

60C1-55 FOR SMALL PLATES
60C1-56 FOR LARGE PLATES

505C3-223 SMALL PLATE FOR 5"-8" KNIVES
505C3-224 LARGE PLATE FOR 9"-13" KNIVES

FOR 50 CY. 1500 R.P.M. & DUAL SPEED MACHINES ONLY
505C3-226 SMALL PLATE FOR 5"-8" KNIVES
505C3-227 LARGE PLATE FOR 9"-13" KNIVES

FOR COMPLETE LIST OF
EASTMAN KNIVES AVAILABLE
SEE PAGE 5.

**Eastmanmachine
COMPANY**

OPTIONAL BEVEL-BLOC® SHARPENER SHOES

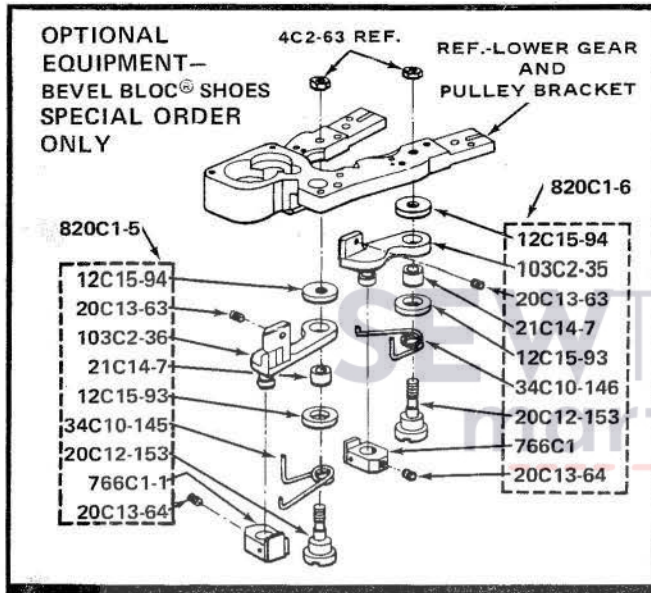

Part No.	Description
4C2-63	L.H. Nut (1 Req'd)
12C15-93	L.H. Washer (1 Req'd)
12C15-94	L.H. Washer - Threaded (1 Req'd)
20C12-153	L.H. Screw for Shoe (1 Req'd)
20C13-63	L.H. Set Screw (1 Req'd)
20C13-64	L.H. Set Screw (1 Req'd)
21C14-7	L.H. Bushing (1 Req'd)
34C10-145	L.H. Spring (1 Req'd)
103C2-36	L.H. Sharpener Shoe (1 Req'd)
766C1-1	L.H. Bevel Block (1 Req'd)
820C1-5	Conversion Kit Complete - L.H. Shoe (1 Req'd)

4C2-63	R.H. Nut (1 Req'd)
12C15-93	R.H. Washer (1 Req'd)
12C15-94	R.H. Washer - Threaded (1 Req'd)
20C12-153	R.H. Screw for Shoe (1 Req'd)
20C13-63	R.H. Set Screw (1 Req'd)
20C13-64	R.H. Set Screw (1 Req'd)
21C14-7	R.H. Bushing (1 Req'd)
34C10-146	R.H. Spring (1 Req'd)
103C2-35	R.H. Sharpener Shoe (1 Req'd)
766C1	R.H. Bevel Block (1 Req'd)
820C1-6	Conversion Kit Complete - R.H. Shoe (1 Req'd)

EASTMAN'S BEVEL BLOC® SHARPENER ASSEMBLY IS COVERED BY PATENT NOS. 2,829,474 AND 3,350,818

TO ADJUST BEVEL BLOC® SHOES Eastman's exclusive patented adjustable Bevel-Bloc sharpener shoes make it possible to grind any desired bevel on the knife edge. The knife edge bevel on your new machine is factory set to handle all normal fabrics and should not be changed. Nor-

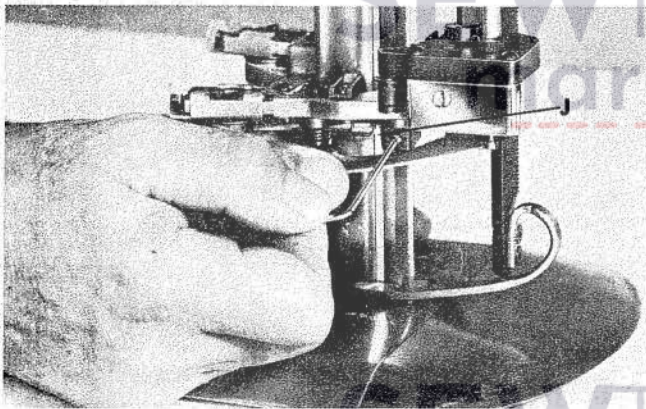

mally an acceptable bevel is 1/16" wide. If necessary to adjust the bevel on the knife edge to a different length proceed as follows:

Refer to diagram on page 3 and lower the knife to the bottom of the stroke with machine turning knob F. Lower the sharpener by hand, by holding the sharpener operating lever E halfway down to its neutral position. To change cutting bevel on knife, pull sharpener belt down to expose set screw on Bevel-Bloc. Insert Allen Key J into set screw and loosen slightly. For longer bevel on knife edge, move key and bloc to the rear; for shorter bevel, to the front. Retighten set screw. Adjust Bevel-Blocs on both shoes. After adjustment of Bevel-Blocs, return sharpener to top (locked) position. Check stop screws on sharpener shoes for correct setting as outlined in instructions on page 4. Color mark front sides of knife edge with marking ink or pencil. Turn on power and run sharpener down and up several times and then check bevel on both sides of knife. Re-adjust if necessary.

GUARANTEE

We guarantee our machines for six months from date of invoice against defective parts and workmanship and will repair or replace any machine going wrong from these causes when returned to us carrying charges prepaid.

This guarantee does not contemplate making good damage caused by misuse or neglect; and is void if other than genuine Eastman knives, abrasive belts and parts are used in the machine.

Eastmanmachine COMPANY

779 WASHINGTON STREET
BUFFALO, NEW YORK 14203
AREA CODE (716) 856-2200